

# U-profiles on top of the glass

## Aluminium U-profiles



- Minimalistic handrail system which gives protection and connects pieces of railing glass to one another
- Suitable for glass thicknesses (mm): 12; 12.76; 13.52; 16.76; 17.52; 20.76; 21.52
- Material: aluminium 6063 T66
- Surface finishing: brushed stainless effect anodized / RAL powder coated
- Installation on the glass with assembly adhesive
- The system includes connection elements and end plates

Code	Glass thickness
HRU.135	12-13.52 mm
HRU.175	16.76-17.52 mm
HRU.215	20.76-21.52 mm

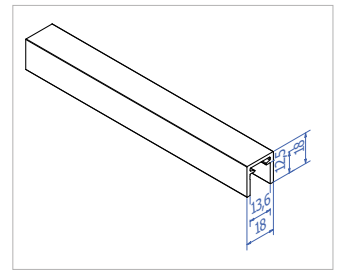

HRU.135

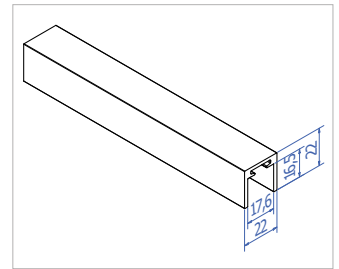

HRU.175

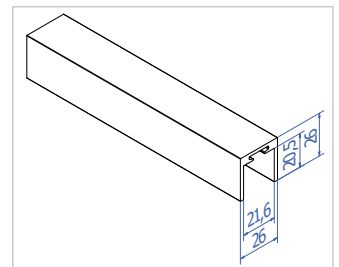

HRU.215

## Aluminium U-profile connection elements



Code	Type
HRU.C1	Corner connection 90°
HRU.C2	Straight connection 180°

INFO: Material: stainless steel  
Installation with assembly adhesive

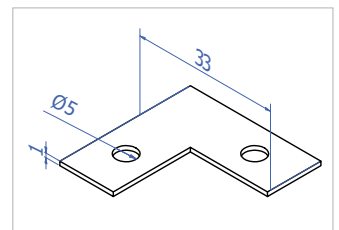

HRU.C1

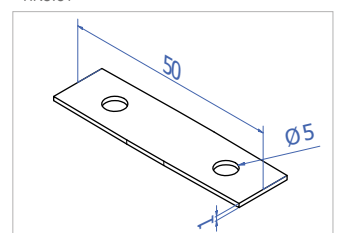

HRU.C2

## Aluminium U-profile end plates



Code	Glass thickness	A x B
HRU.EC135	12-13.52 mm	18 x 18 mm
HRU.EC175	16.76-17.52 mm	22 x 22 mm
HRU.EC215	20.76-21.52 mm	26 x 26 mm

INFO: Material: stainless steel  
Installation with assembly adhesive

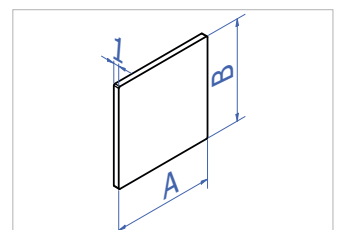



**R · FIX**

[www.rfix.eu](http://www.rfix.eu)