



Glass railing with posts and accessories

# Glass railing with posts and accessories

## Ø42.4 round baluster posts and handrail

Classic round baluster posts and handrails made of stainless steel allow you to create high-quality and exclusive glass railings. The standard surface finishing of round posts is brushed stainless steel, but they can also be painted RAL colours, if desired. The advantage of stainless steel baluster posts over black steel posts is very good corrosion resistance and a nice appearance for a long time.

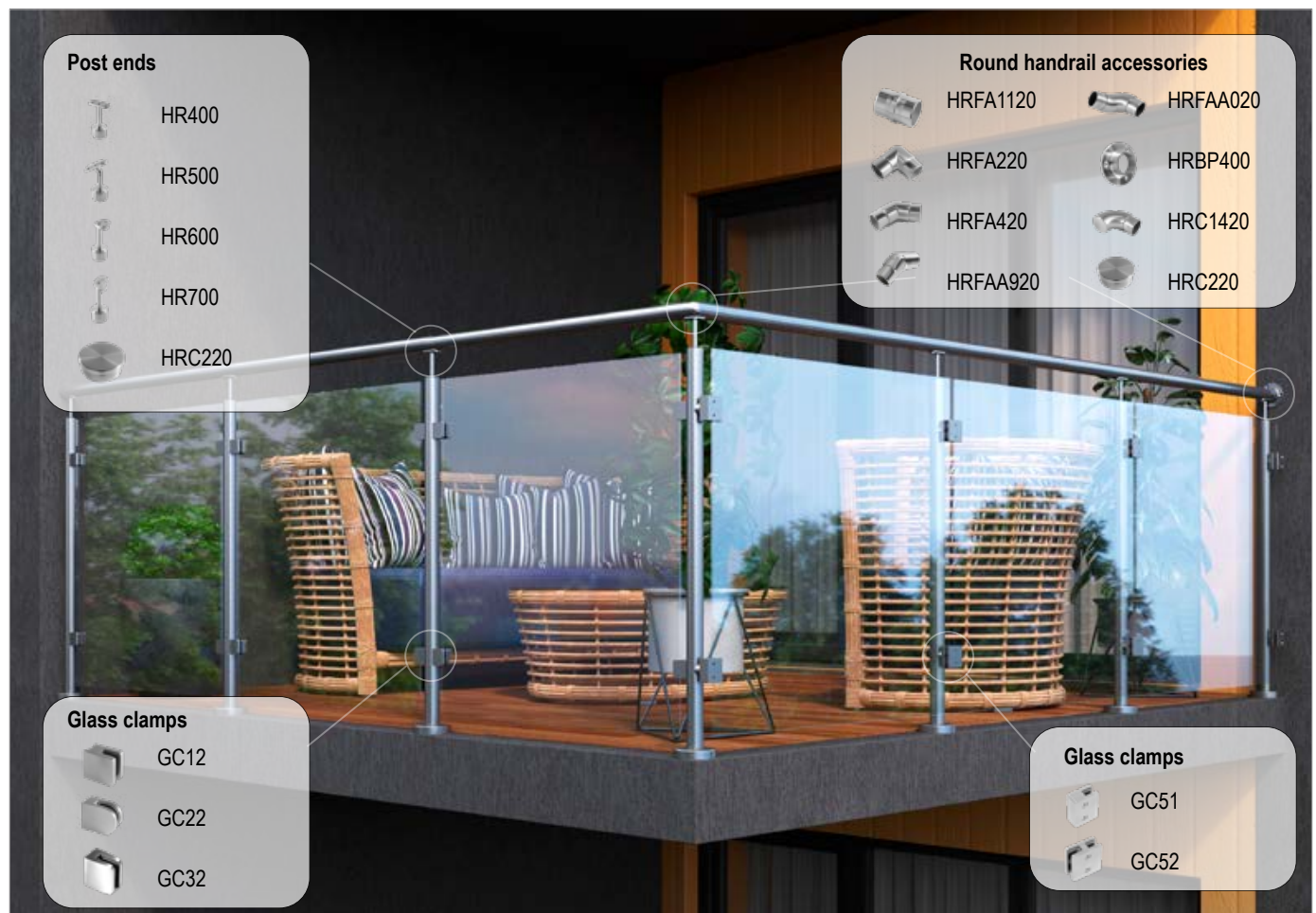

- The posts are made of Ø42.4x2 stainless steel pipe
- Post lengths and clamp locations as per request
- Material: for indoor use 304 (1.4301) or for outdoor use 316 (1.4401)
- Surface finishing: brushed stainless steel or RAL powder coated
- Posts with bottom fastening or side fastening
- Possibility to use different glass clamps and railings
- Tested to the railing linear load up to 1 kN/m

INFO: The package contains baluster posts in unassembled state.  
To attach handrail holders, you need to order stainless steel adhesive.

## Ø42.4 round baluster posts and handrail

### Base fixed round post



Material	Number of clamps	Code
304	-	SPB42.04
304	2	SPB42.04.2
304	4	SPB42.04.4
316	-	SPB42.16
316	2	SPB42.16.2
316	4	SPB42.16.4

INFO: Dimensions on request.

Linear load resistance up to 1 kN/m.

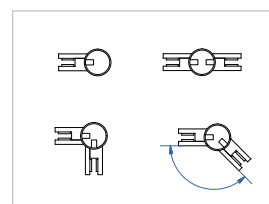
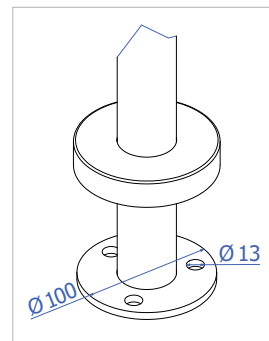

### Side fixed round post (model SPC)



Material	Number of clamps	Code
304	-	SPC42.04
304	2	SPC42.04.2
304	4	SPC42.04.4
316	-	SPC42.16
316	2	SPC42.16.2
316	4	SPC42.16.4

INFO: Dimensions on request.

Linear load resistance up to 1 kN/m.

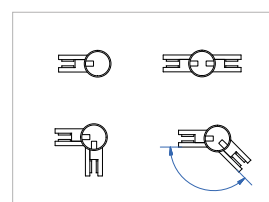
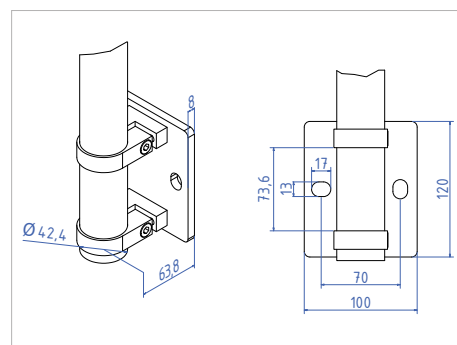

### Side fixed round post (model SPS)



Material	Number of clamps	Code
304	-	SPS42.04
304	2	SPS42.04.2
304	4	SPS42.04.4
316	-	SPS42.16
316	2	SPS42.16.2
316	4	SPS42.16.4

INFO: Dimensions on request.

Linear load resistance up to 0.5 kN/m.

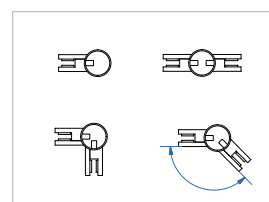
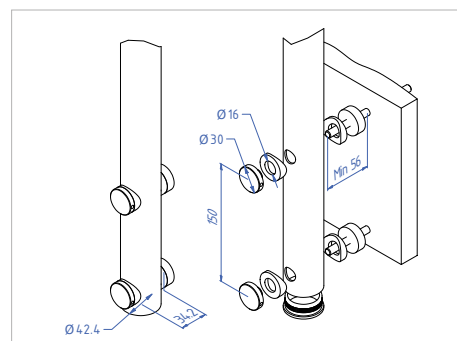



## 40x40 rectangular baluster posts and handrail

Modern rectangular baluster posts and handrails made of stainless steel allow you to create high-quality and exclusive glass railings. The standard surface finishing of rectangular posts is brushed stainless steel, but they can also be painted in RAL colours, if desired. The advantage of stainless steel baluster posts over black steel posts is very good corrosion resistance and a nice appearance for a long time.

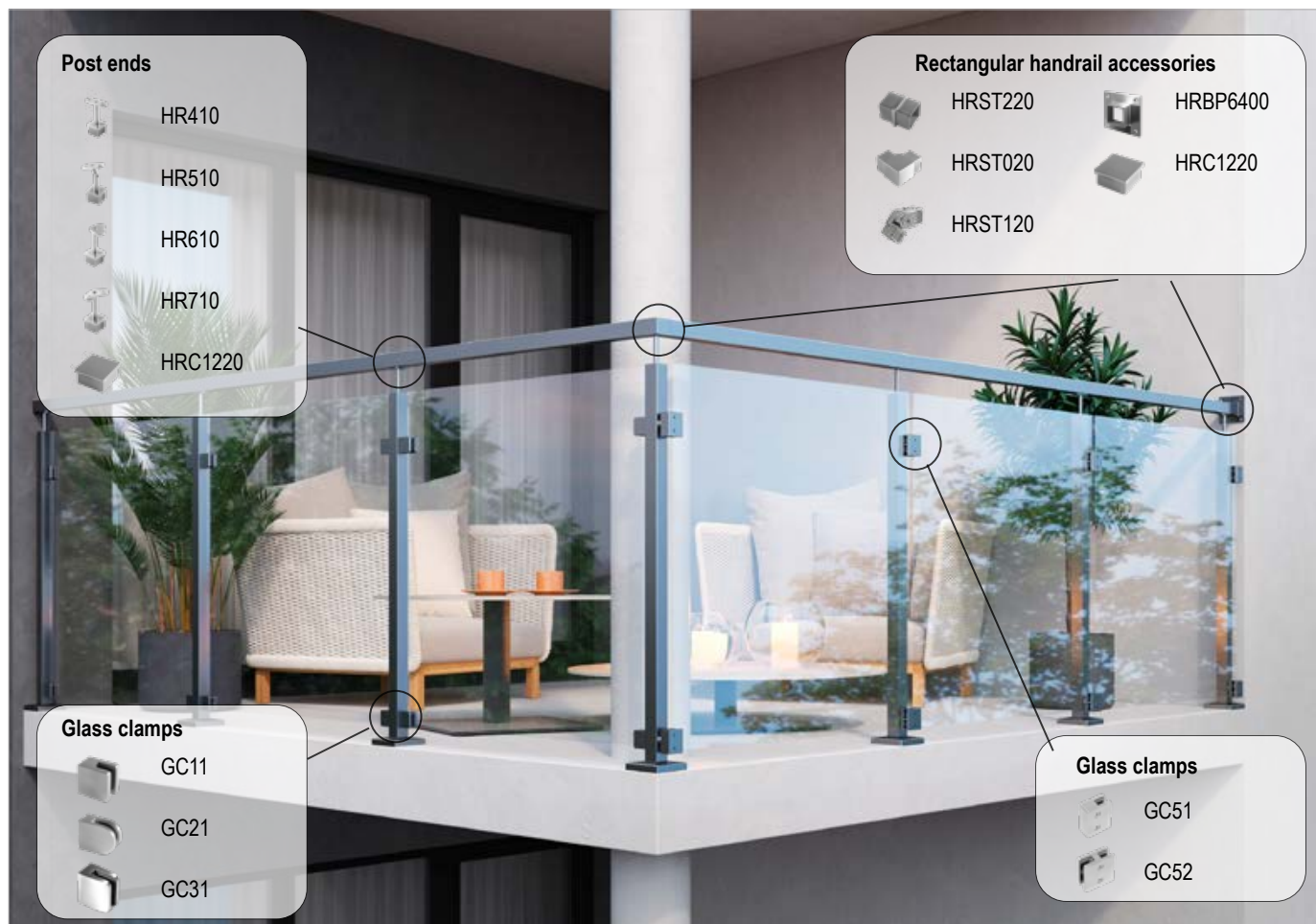

- The posts are made of 40x40x2 stainless steel pipe
- Post lengths and clamp locations as per request
- Material: for indoor use 304 (1.4301) or for outdoor use 316 (1.4401)
- Surface finishing: brushed stainless steel or RAL powder coated
- Posts with bottom fastening or side fastening
- Possibility to use different glass clamps and railings
- Tested to the railing linear load up to 1 kN/m

INFO: The package contains baluster posts in unassembled state.  
To attach handrail holders, you need to order stainless steel adhesive.

## 40x40 rectangular baluster posts and handrail

### Base fixed rectangular post



Material	Number of clamps	Code
304	-	SPB40.04
304	2	SPB40.04.2
304	4	SPB40.04.4
316	-	SPB40.16
316	2	SPB40.16.2
316	4	SPB40.16.4

INFO: Dimensions on request.

Linear load resistance up to 1 kN/m.

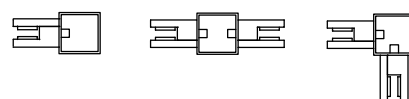
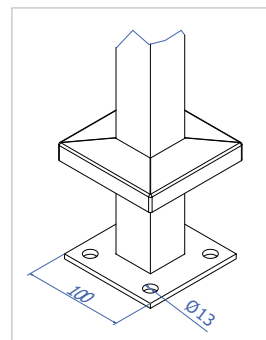

### Side fixed rectangular post (model SPC)



Material	Number of clamps	Code
304	-	SPC40.04
304	2	SPC40.04.2
304	4	SPC40.04.4
316	-	SPC40.16
316	2	SPC40.16.2
316	4	SPC40.16.4

INFO: Dimensions on request.

Linear load resistance up to 1 kN/m.

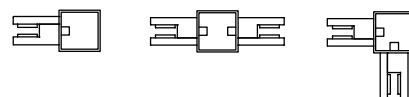
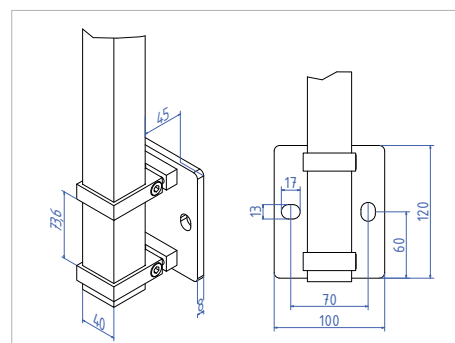

### Side fixed rectangular post (model SPS)



Material	Number of clamps	Code
304	-	SPS40.04
304	2	SPS40.04.2
304	4	SPS40.04.4
316	-	SPS40.16
316	2	SPS40.16.2
316	4	SPS40.16.4

INFO: Dimensions on request.

Linear load resistance up to 0.5 kN/m.

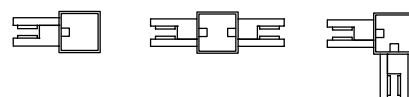
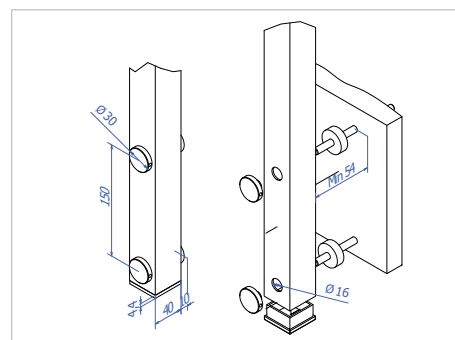

## Post fastening clamps

### Baluster post clamp for Ø42.4mm pipe



Code	Material
SPC42.A1	316

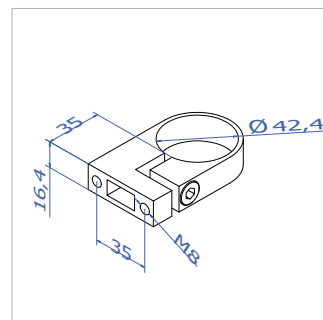

### Baluster post clamp with fastening plate for Ø42.4 mm pipe



Code	Material
SPC42.B1	316

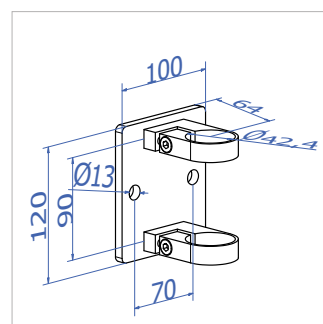

### Baluster post clamp for 40x40 mm pipe



Code	Material
SPC40.A1	316

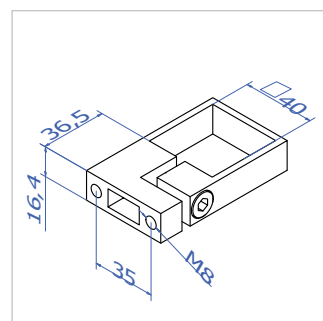

### Baluster post clamp with fastening plate for 40x40 mm pipe



Code	Material
SPC40.B1	316

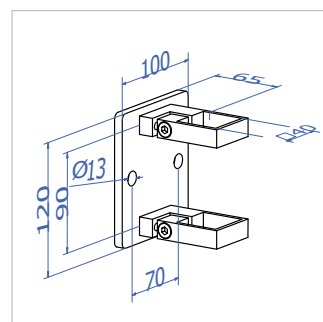

## Glass clamps

### Glass clamp GC11



Code	Dimensions	Material
GC11.S4	45x45 mm	304
GC11.S16	45x45 mm	316
GC11.ZS	45x45 mm	zamak, SS-effect
GC11.ZR	45x45 mm	zamak, raw

INFO: Possibility to use safety plate.

The set includes glass seals and a safety pin.

Glass thickness: 6; 8; 8.76; 10; 10.76 mm

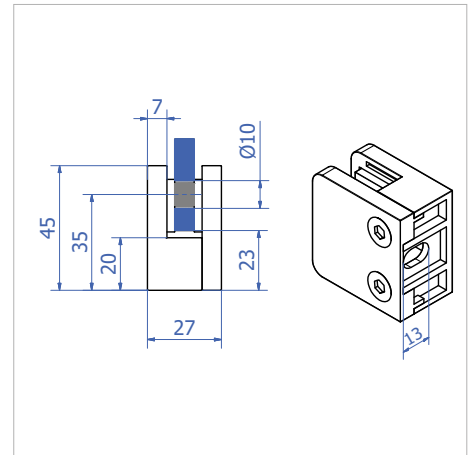

### Glass clamp GC12



Code	Dimensions	Material
GC12.S4	45x45 mm	304
GC12.S16	45x45 mm	316
GC12.ZS	45x45 mm	zamak, SS-effect
GC12.ZR	45x45 mm	zamak, raw

INFO: Possibility to use safety plate.

The set includes glass seals and a safety pin.

Glass thickness: 6; 8; 8.76; 10; 10.76 mm

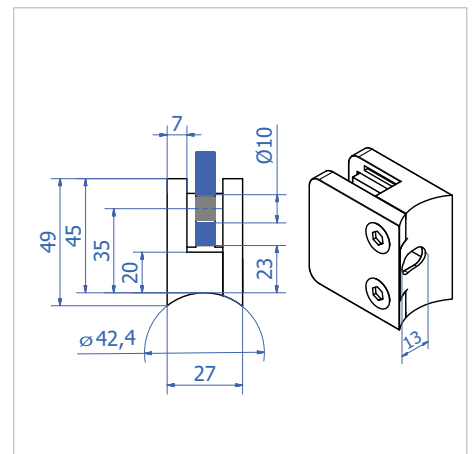

### Safety plate for a clamp GC11 and GC12



Code	Material
GCP.S16	316
GCP.ZS	zamak, SS-effect
GCP.ZR	zamak, raw

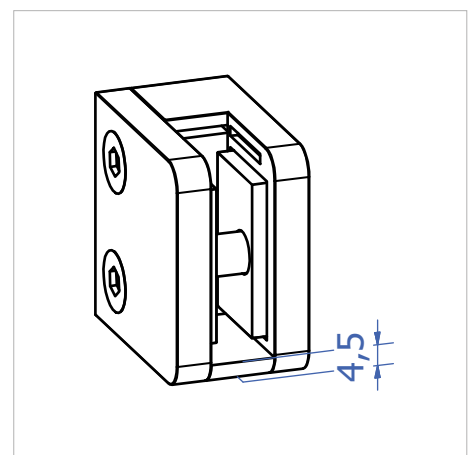

# Glass railing with posts and accessories

## Glass clamps

### Glass clamp GC21



Code	Dimensions	Material
GC21.S4	50x40 mm	304
GC21.S16	50x40 mm	316

INFO:

The set includes glass seals and a safety pin.

Glass thickness: 6; 8; 8.76; 10; 10.76 mm

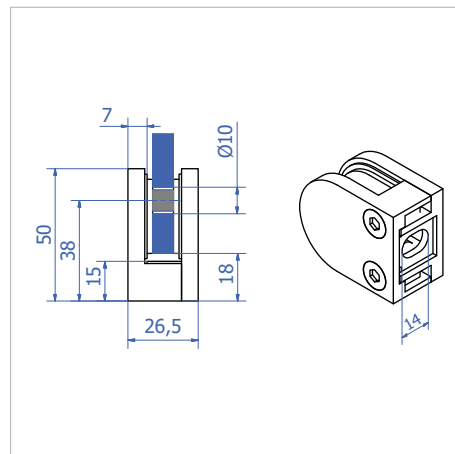

### Glass clamp GC22



Code	Dimensions	Material
GC22.S4	50x40 mm	304
GC22.S16	50x40 mm	316

INFO:

The set includes glass seals and a safety pin.

Glass thickness: 6; 8; 8.76; 10; 10.76 mm

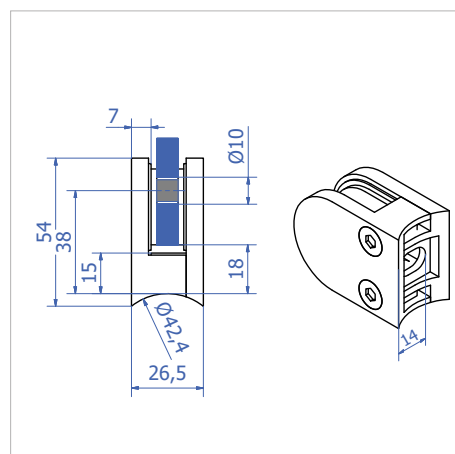

### Glass clamp GC91



Code	Dimensions	Material
GC91.S4	30x30 mm	304

INFO: Cannot be used in load-bearing glass railings.

The set includes glass seals.

Glass thickness: 4; 6; 8 mm

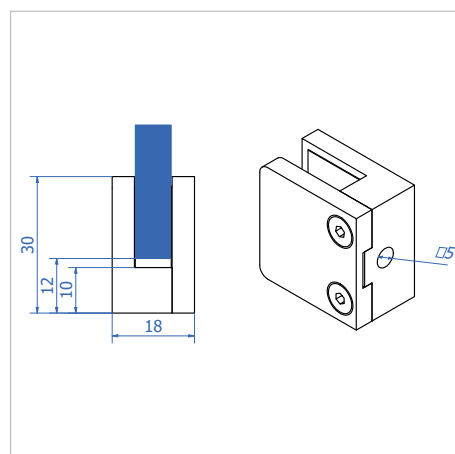



## Glass clamps

### Glass clamp GC31



Code	Dimensions	Material
GC31.S4	52x52 mm	304
GC31.S16	52x52 mm	316

INFO: The set includes glass seals, a safety plate and a safety pin.

Glass thickness: 8; 8.76; 10; 10.76; 12; 12.76; 13.52 mm

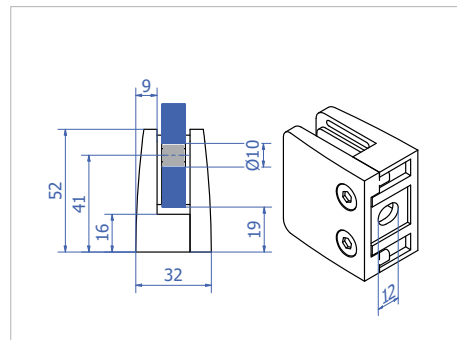

### Glass clamp GC32



Code	Dimensions	Material
GC32.S4	52x52 mm	304
GC32.S16	52x52 mm	316

INFO: The set includes glass seals, a safety plate and a safety pin.

Glass thickness: 8; 8.76; 10; 10.76; 12; 12.76; 13.52 mm

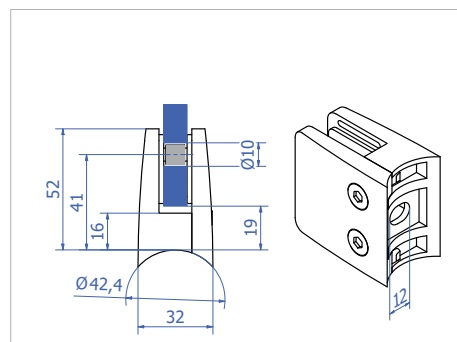

# Glass railing with posts and accessories

## Glass clamps

### Glass clamp GC51



Code	Material
GC51.S16	316

INFO: The set includes glass seals. Possibility to use safety plate.

Glass thickness: 8; 8.76; 10; 10.76; 12; 12.76 mm

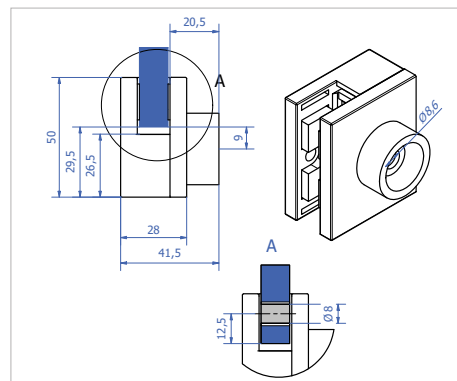

INFO: The set does not include safety pins, available to order.

### Glass clamp GC52



Code	Material
GC52.S16	316

INFO: The set includes glass seals. Possibility to use safety plate.

Glass thickness: 8; 8.76; 10; 10.76; 12; 12.76 mm

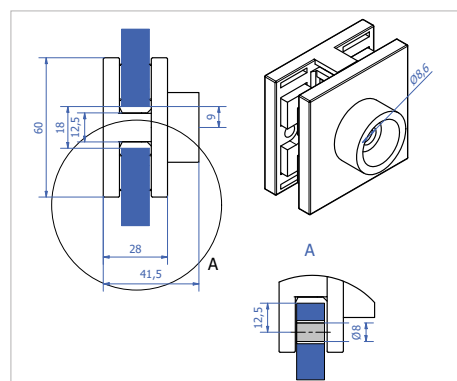

INFO: The set does not include safety pins, available to order.

### Safety plate for GC5 clamps.



Code	Material
GC5P.S16	316



### Ø42.4 tube adapter for GC5 clamp



Code	Material
GC5A42.S16	316

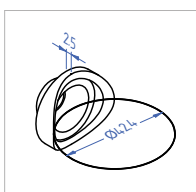



French balcony with GC51 clamps



Glass railing with GC51 and GC52 clamps

# Glass railing with posts and accessories

## Handrail holders

### Handrail holder for post Ø42.4x2



Code	Material	Saddle for handrail
HR400.00	316	Flat
HR400.42	316	Round Ø42.4

INFO: Use adhesive HR.GLUE

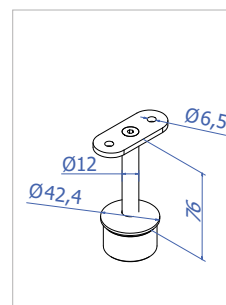

HR 400.00

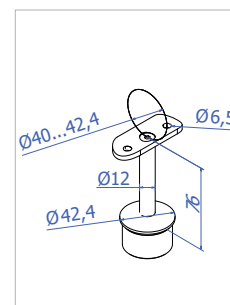

HR 400.42

### Handrail holder for post Ø42.4x2



Code	Material	Saddle for handrail
HR500.00	316	Flat
HR500.42	316	Round Ø42.4

INFO: Use adhesive HR.GLUE

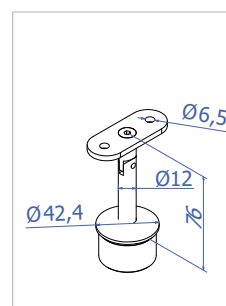

HR 500.00

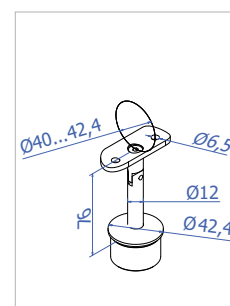

HR 500.42

### Handrail holder for post Ø42.4x2



Code	Material	Saddle for handrail
HR600.00	316	Flat
HR600.42	316	Round Ø42.4

INFO: Use adhesive HR.GLUE

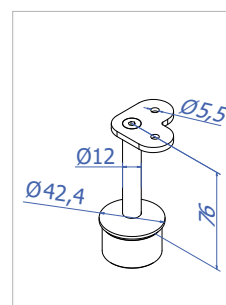

HR 600.00

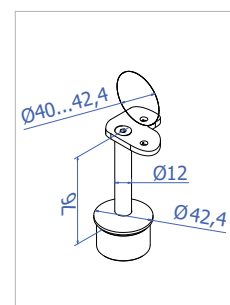

HR 600.42

### Handrail holder for post Ø42.4x2



Code	Material	Saddle for handrail
HR700.00	316	Flat
HR700.42	316	Round Ø42.4

INFO: Use adhesive HR.GLUE

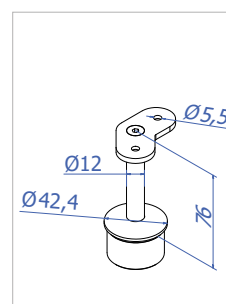

HR 700.00

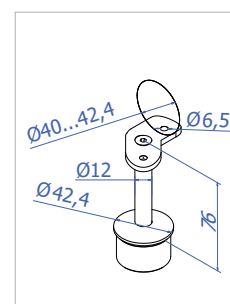

HR 700.42

## Handrail holders

### Handrail holder for post 40x40x2



Code	Material	Saddle for handrail
HR410.00	316	Flat
HR410.42	316	Round Ø42.4

INFO: Use adhesive HR.GLUE

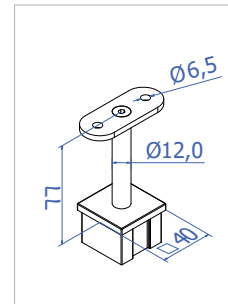

HR 410.00

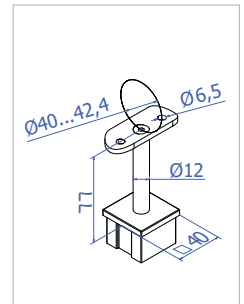

HR 410.42

### Handrail holder for post 40x40x2



Code	Material	Saddle for handrail
HR510.00	316	Flat
HR510.42	316	Round Ø42.4

INFO: Use adhesive HR.GLUE

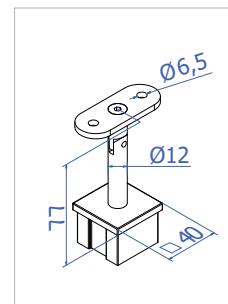

HR 510.00

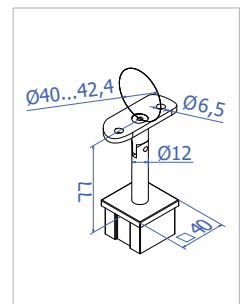

HR 510.42

### Handrail holder for post 40x40x2



Code	Material	Saddle for handrail
HR610.00	316	Flat
HR610.42	316	Round Ø42.4

INFO: Use adhesive HR.GLUE

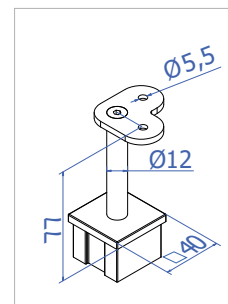

HR 610.00

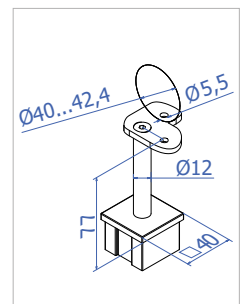

HR 610.42

### Handrail holder for post 40x40x2



Code	Material	Saddle for handrail
HR710.00	316	Flat
HR710.42	316	Round Ø42.4

INFO: Use adhesive HR.GLUE

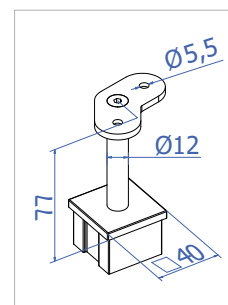

HR 710.00

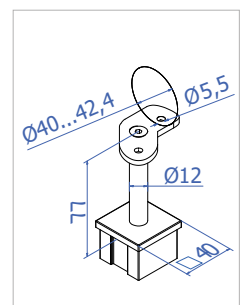

HR 710.42



# Glass railing with posts and accessories

## Handrail holders

### Handrail holder for wall, M8 thread



Code	Material	Saddle for handrail
HR1200	316	-
HR1200.00	316	Flat
HR1200.42	316	Round Ø42.4

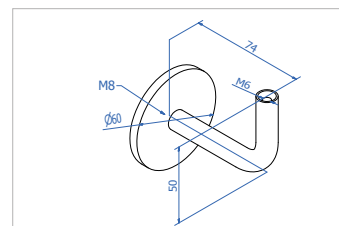

HR 1200

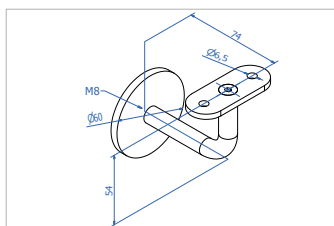

HR 1200.00

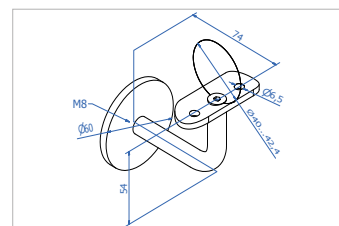

HR 1200.42

### Handrail holder for wall, 3 screw holes



Code	Material	Saddle for handrail
HR1600	316	-
HR1600.00	316	Flat
HR1600.42	316	Round Ø42.4

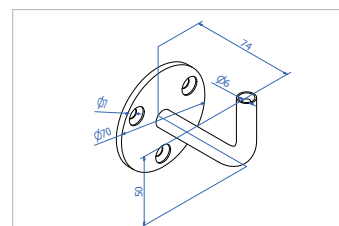

HR 1600

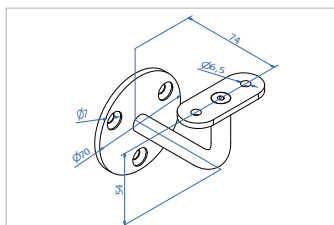

HR 1600.00

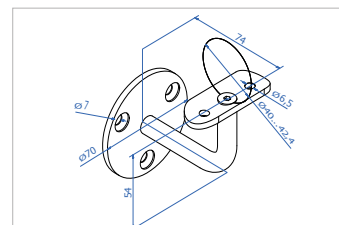

HR 1600.42

### Handrail holder for glass



Code	Material	Saddle for handrail
HR1300	316	-
HR1300.00	316	Flat
HR1300.42	316	Round Ø42.4

INFO: glass opening Ø22 mm

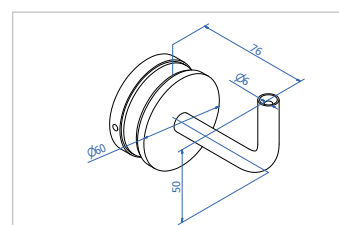

HR 1300

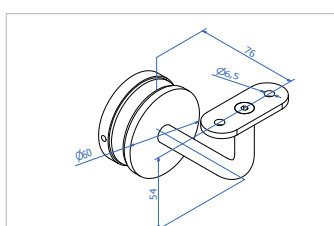

HR 1300.00

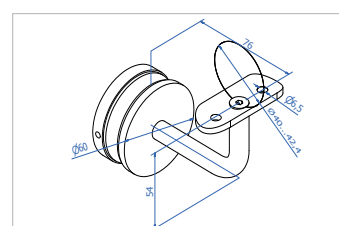

HR 1300.42

## Handrail accessories

### Handrail holder for wall, 3 screw holes



Code	Material	Saddle for handrail
HR1500.00	304	Flat
HR1500.42	304	Round Ø42.4

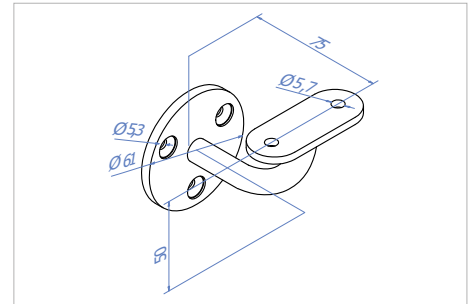

HR1500.00

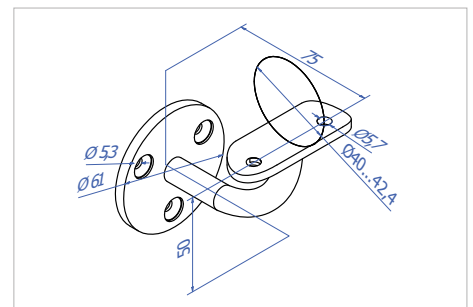

HR1500.42

### Ø42.4x2 brushed pipe



Code	Material
TD424x2.304	304
TD424x2.316	316

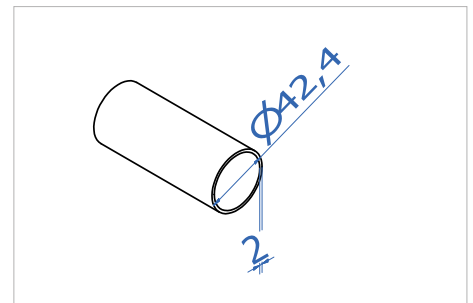

### Ø42.4x2 pipe connector 180°



Code	Material
HRFA1120	316

INFO: Use adhesive HR.GLUE

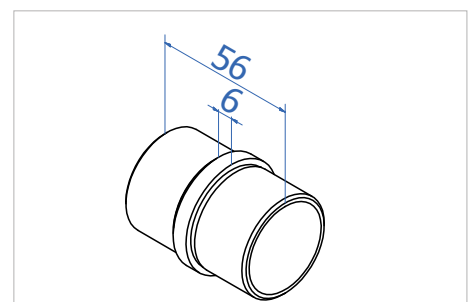

# Glass railing with posts and accessories

## Handrail accessories

### Ø42.4x2 pipe connector 90°



Code	Material
HRFA220	316

INFO: Use adhesive HR.GLUE

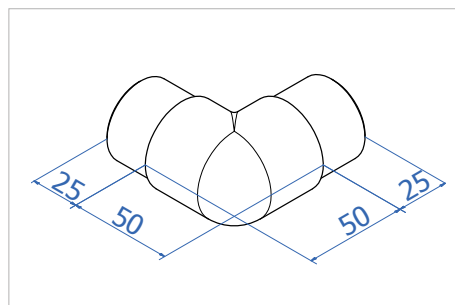

### Ø42.4x2 pipe connector 135°



Code	Material
HRFA420	316

INFO: Use adhesive HR.GLUE

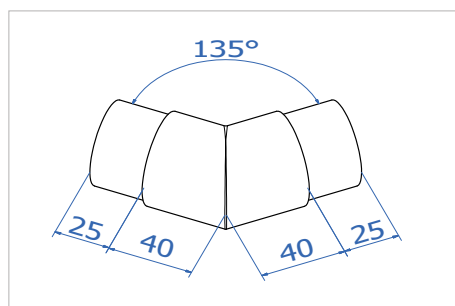

### Ø42.4x2 pipe connector, adjustable



Code	Material
HRFAA920	316

INFO: Use adhesive HR.GLUE

Adjustable angle 110-180°

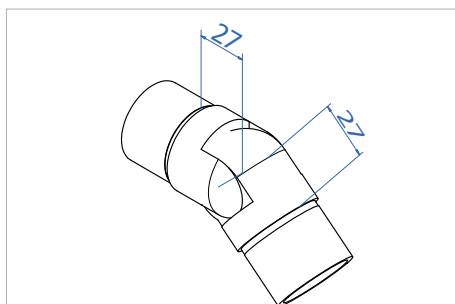

### Ø42.4x2 pipe connector, adjustable 45°/45°



Code	Material
HRFAA020	316

INFO: Use adhesive HR.GLUE

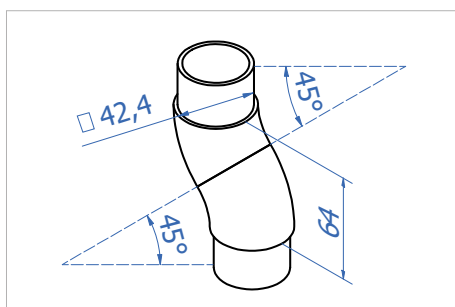

## Handrail accessories

### Ø42.4x2 pipe wall flange



Code	Material
HRBP400	316

INFO: The pipe is fixed with a retaining screw.

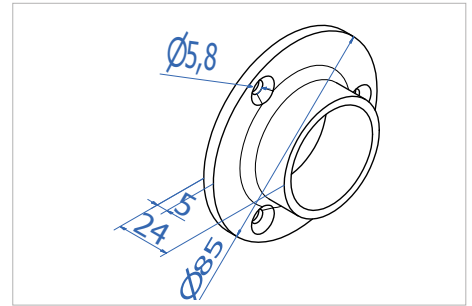

### Ø42.4x2 pipe end cap, turned down



Code	Material
HRC1420	316

INFO: Use adhesive HR.GLUE

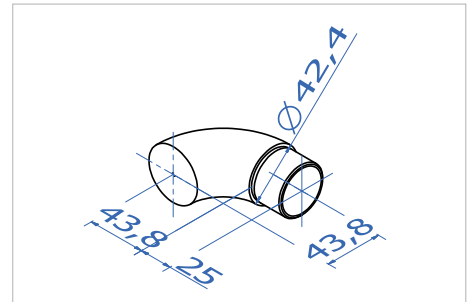

### Ø42.4x2 end cap



Code	Material
HRC220	316

INFO: Use adhesive HR.GLUE

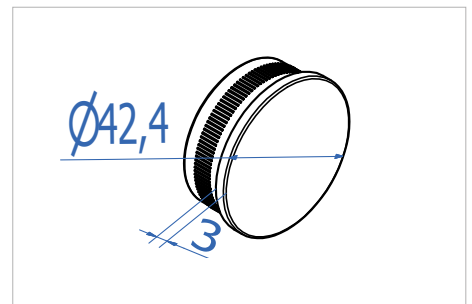

### Ø42.4x2 end cap with M8 thread



Code	Material
HRC220M8V	316

INFO: Use adhesive HR.GLUE

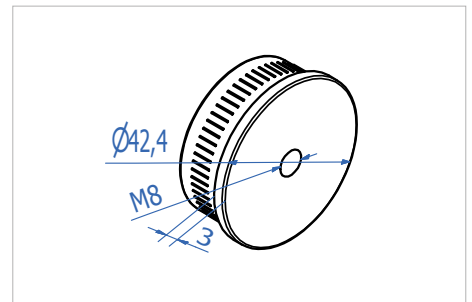

### Ø42.4x2 pipe end cap with M8 thread, curved



Code	Material
HRC220M8	316

INFO: Use adhesive HR.GLUE

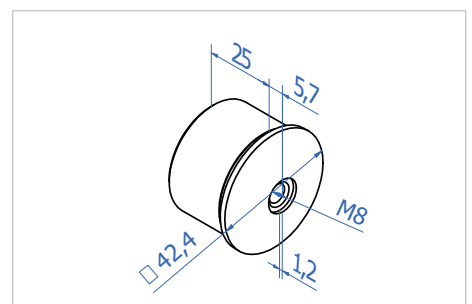

## Handrail accessories

### 40x40x2 brushed pipe



Code	Material
T40402.304	304
T40402.316	316

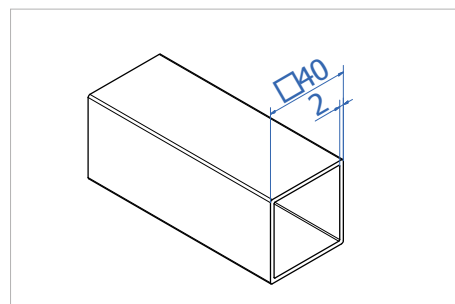

### 40x40x2 pipe connector 180°

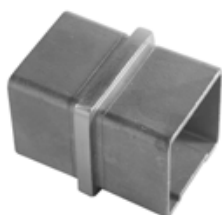

Code	Material
HRST220	316

INFO: Use adhesive HR.GLUE

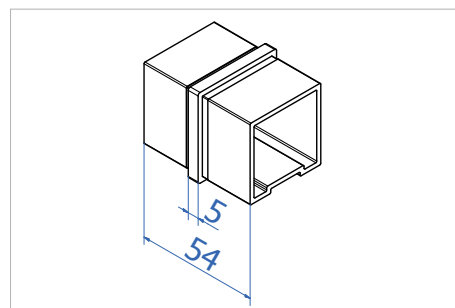

### 40x40x2 pipe connector 90°



Code	Material
HRST020	316

INFO: Use adhesive HR.GLUE

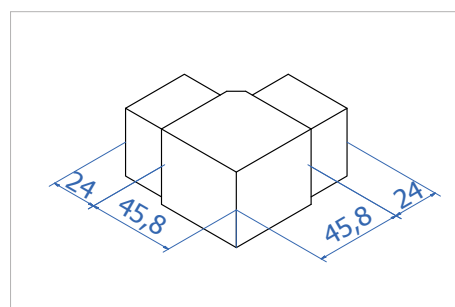

### 40x40x2 pipe connector, adjustable



Code	Material
HRST120	316

INFO: Use adhesive HR.GLUE

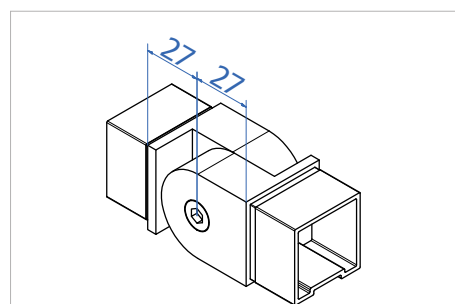



## Handrail accessories

### 40x40x2 pipe wall flange



Code	Material
HRBP600	316

INFO: The pipe is fixed with a retaining screw.

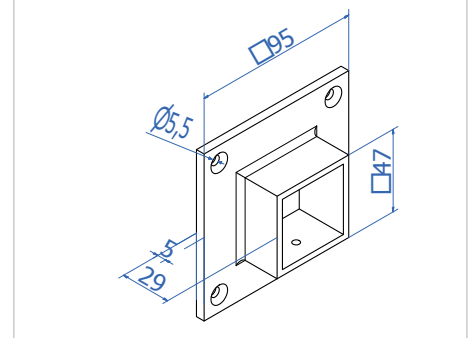

### 40x40x2 pipe end cap



Code	Material
HRC1220	316

INFO: Use adhesive HR.GLUE

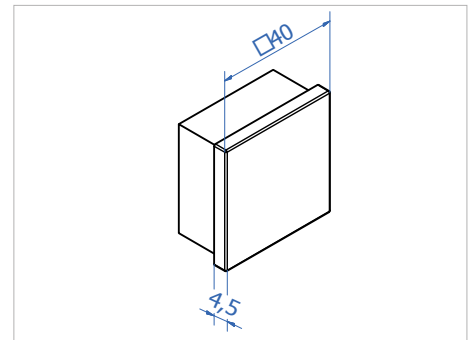

### 40x40x2 pipe end cap with M8 thread



Code	Material
HRC1320M8	316

INFO: Use adhesive HR.GLUE

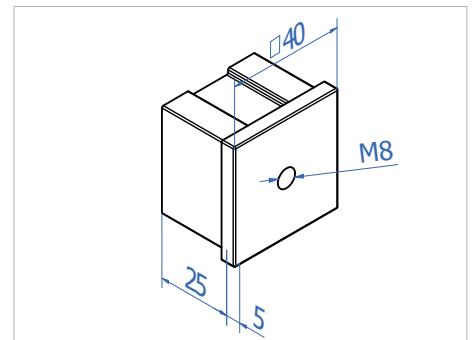

# Glass railing with posts and accessories

## Accessories

### Ø42.4 post base cover

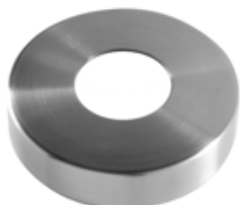

Code	Material
HRBC015	316

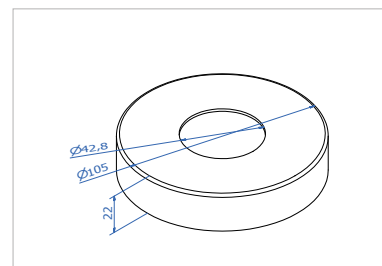

### 40x40 post base cover

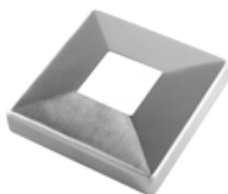

Code	Material
HRBC115	316

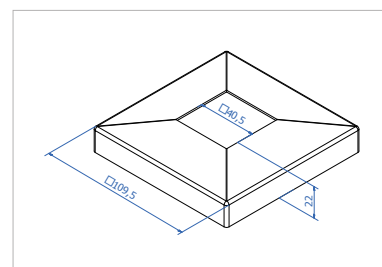

### Stainless steel adhesive



Code	Quantity
HR.GLUE	50 ml
HR.GLUE.S	10 ml

INFO: Adhesive consumption for one adhesive bond is up to 1 ml

### Cleaning and maintenance foam for stainless steel



Code	Quantity
HR.CLEAN	600 ml

INFO: It is recommended to use it always after installation work.

**R · FIX**

[www.rfix.eu](http://www.rfix.eu)